

## Parts List - TW253

**TW253 3.8m TIG Torch**  
**TW253 7.6m TIG Torch**

**1415024 (BSP Fitting)**  
**1415025 (BSP Fitting)**

**1415177 (Central Adaptor Fitting)**  
**1415178 (Central Adaptor Fitting)**

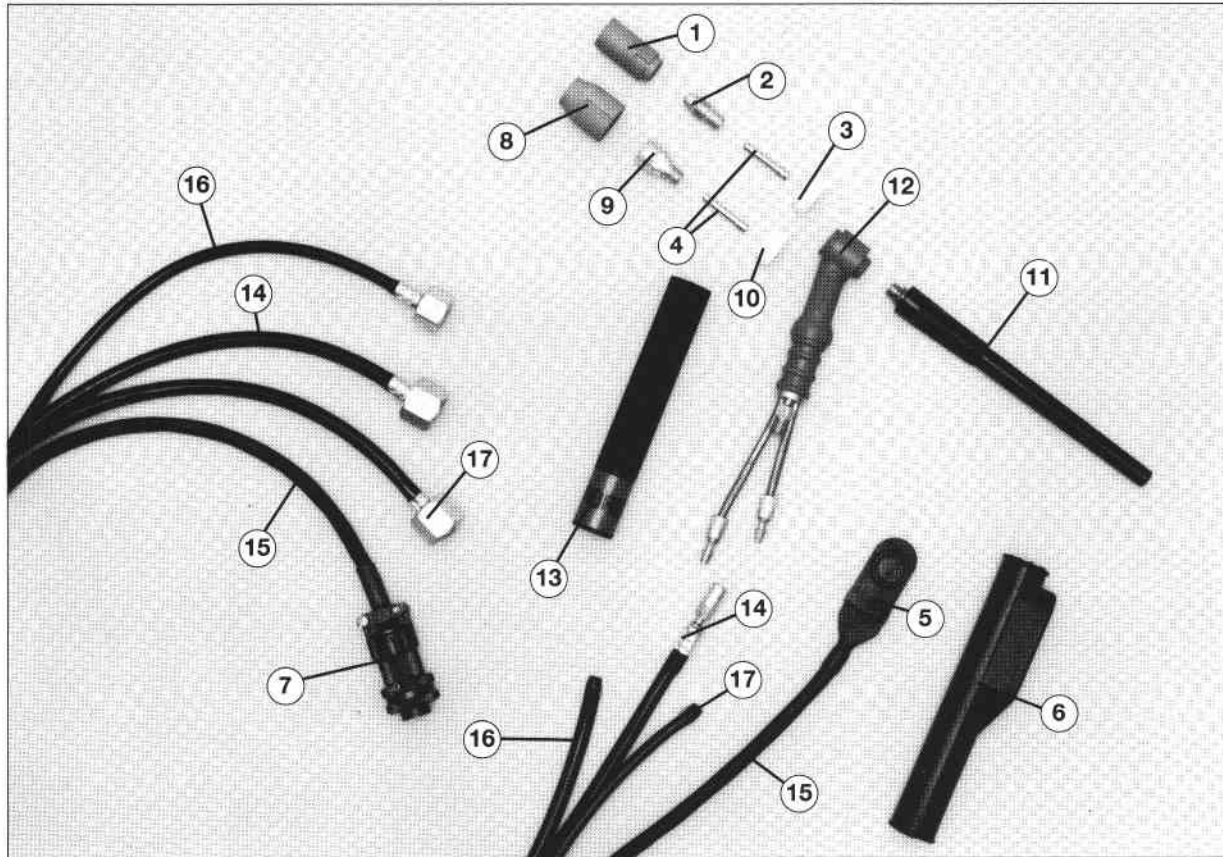

### Nozzles / Collet Bodies

▲ 1	Ceramic Nozzle 29mm x 6mm Pk10	1408340
▲ 1	Ceramic Nozzle 29mm x 8mm Pk10	1408341
● 1	Ceramic Nozzle 29mm x 10mm Pk10	1408342
● 1	Ceramic Nozzle 29mm x 11mm Pk10	1408343
▲ 1	Ceramic Nozzle 29mm x 13mm Pk10	1408344
* 2	Collet Body 0.5mm	1408080
* 2	Collet Body 1.0mm	1408081
*▲ 2	Collet Body 1.6mm	1408082
*● 2	Collet Body 2.4mm	1408083
*▲ 2	Collet Body 3.2mm	1408084
3	Nozzle Gasket	1411633

### Collets

4	Collet 0.5mm Pk5	1410880
4	Collet 1.0mm Pk5	1410881
4	Collet 1.6mm Pk5	1410882
4	Collet 2.4mm Pk5	1410883
4	Collet 3.2mm Pk5	1410884

### Switches and Components

● 5	Momentary Switch (SW1F)	1411668
● 6	Switch Boot 19mm dia. (SW1F)	1411670

### Torch Switch Plugs

● 7	Plug 2-pin	1407817
7	Plug 3 Pin	607574
7	Plug 4 Pin	627018
7	Plug 6 Pin	607771

### Optional

NS	3/8" BSP - 35mm2 Dinse Adaptor	1414762
----	--------------------------------	---------

### Nozzles / Gas Lenses

8	Gas Lens Nozzle 25mm x 6mm Pk5	1408360
8	Gas Lens Nozzle 25mm x 8mm Pk5	1408361
8	Gas Lens Nozzle 25mm x 10mm Pk5	1408362
8	Gas Lens Nozzle 25mm x 11mm Pk5	1408363
* 9	Gas Lens Collet Body 0.5mm	1408100
* 9	Gas Lens Collet Body 1.0mm	1408101
* 9	Gas Lens Collet Body 1.6mm	1408102
* 9	Gas Lens Collet Body 2.4mm	1408103
* 9	Gas Lens Collet Body 3.2mm	1408104
10	Gas Lens Insulator	1411633

### Components

		BSP	Central Adaptor
▲ NS	Short Back Cap with O Ring	1408140	-
NS	Medium Back Cap with O Ring	1408141	-
● 11	Long Back Cap with O Ring	1408142	-
12	Torch Body	1411634	-
13	Torch Handle 19mm Diameter	1411635	-
◆ 14	Power/Water Lead Assembly 3.8m	1415636	1415186
◆ 14	Power/Water Lead Assembly 7.6m	1415639	1415187
15	Torch Switch Leads 3.8m	1415038	-
15	Torch Switch Leads 7.6m	1415039	-
+ 16	Gas Hose 3.8m	1411638	1415191
+ 16	Gas Hose 7.6m	1411641	1415193
■ 17	Water Hose 3.8m	1411637	1415190
■ 17	Water Hose 7.6m	1411640	1415192
● NS	Neoprene Rubber 13.7m	1411674	-
NS	Protective Zip Cover 3.1m	1411672	-
NS	Protective Zip Cover 6.7m	1411673	-
NS	Torch Accessory Kit	1408023	-

### KEY

- \* Collet Bodies include one collet of matching size
- ◆ Coaxial power/water cable fitted with 3/8" BSP nut and bullnose fitting
- + Gas hose fitted with 1/4" BSP nut & nipple
- Water hose fitted with 3/8" BSP nut and bullnose fitting

- Consumable items supplied with the torch
- ▲ Items contained in the accessory kit
- NS Not Shown