

## Parts List - TG123V

**TG123V 3.8m TIG Torch**  
**TG123V 7.6m TIG Torch**

**1411615**  
**1411620**

**125 Amps @ 60% Duty Cycle DC-ve**  
**75 Amps @ 60% Duty Cycle AC**

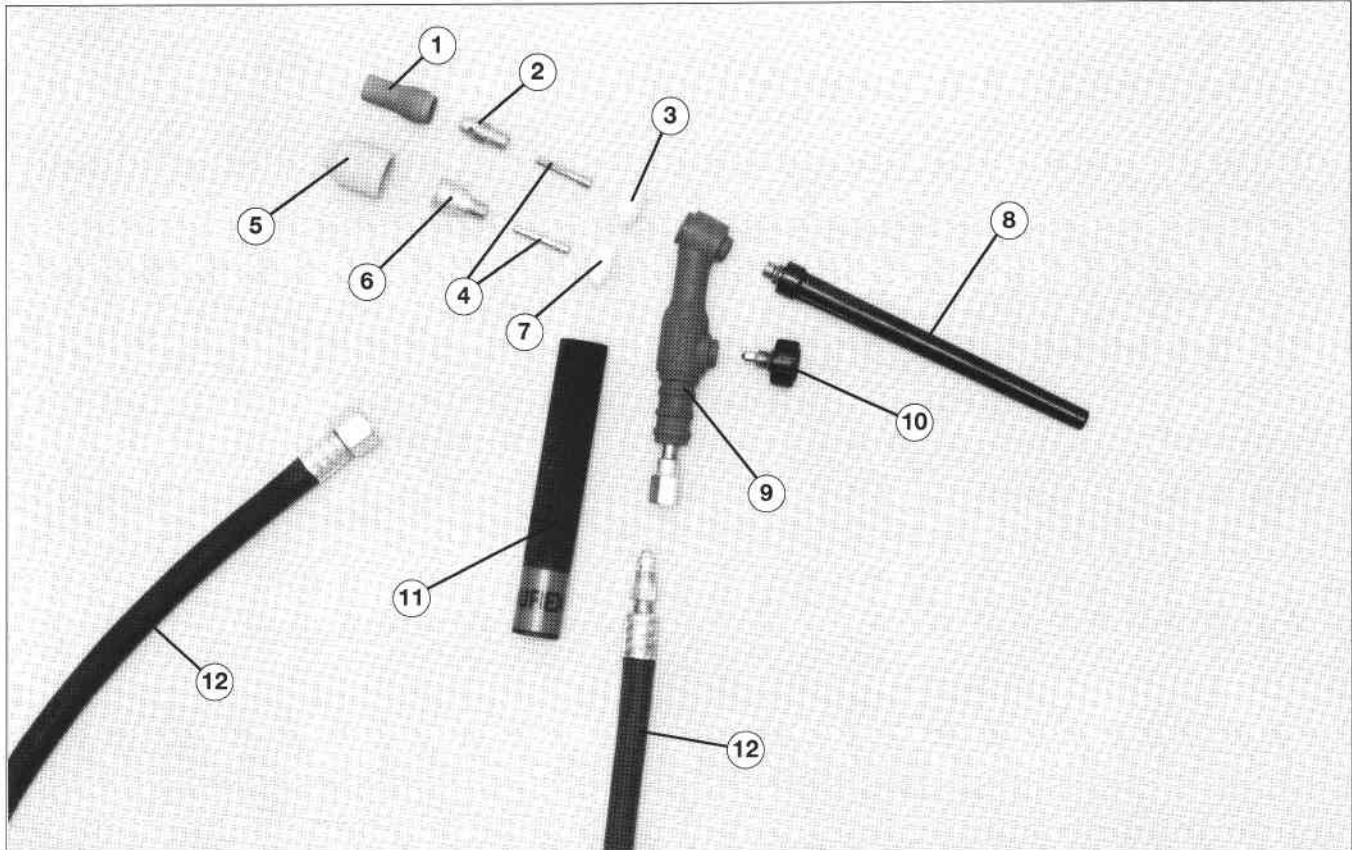

<b>Nozzles / Collet Bodies</b>		
▲ 1	Ceramic Nozzle 47mm x 6mm Pk10	1408340
● 1	Ceramic Nozzle 47mm x 8mm Pk10	1408341
▲ 1	Ceramic Nozzle 47mm x 10mm Pk10	1408342
▲ 1	Ceramic Nozzle 47mm x 11mm Pk10	1408343
1	Ceramic Nozzle 47mm x 13mm Pk10	1408344
* 2	Collet Body 0.5mm	1408080
*▲2	Collet Body 1.0mm	1408081
*●2	Collet Body 1.6mm	1408082
*▲2	Collet Body 2.4mm	1408083
3	Nozzle Gasket	1411633

<b>Collets</b>		
4	Collet 0.5mm Pk5	1410880
4	Collet 1.0mm Pk5	1410881
4	Collet 1.6mm Pk5	1410882
4	Collet 2.4mm Pk5	1410883

<b>Switches and Components</b>		
NS	Momentary Switch (SW1F)	1411668
NS	On/Off Switch (SW2)	1411669
NS	Strap-On Switch (SW3)	1411735
NS	Switch Kit 3.8m (SW3)	1412221
NS	Switch Kit 7.6m (SW3)	1412222
NS	Switch Boot 19mm dia. (SW1F)	1411670
NS	Switch Boot 19mm dia. (SW2)	1411671

<b>Nozzles / Gas Lenses</b>		
5	Gas Lens Nozzle 41mm x 6mm Pk5	1408360
5	Gas Lens Nozzle 41mm x 8mm Pk5	1408361
5	Gas Lens Nozzle 41mm x 10mm Pk5	1408362
5	Gas Lens Nozzle 41mm x 11mm Pk5	1408363
* 6	Gas Lens Collet body 0.5mm	1408100
* 6	Gas Lens Collet Body 1.0mm	1408101
* 6	Gas Lens Collet Body 1.6mm	1408102
* 6	Gas Lens Collet Body 2.4mm	1408103
7	Gas Lens Insulator	1411633

<b>Components</b>		
▲ NS	Short Back Cap with O Ring	1408140
NS	Medium Back Cap with O Ring	1408141
● 8	Long Back Cap with O Ring	1408142
9	Torch Body	1411625
10	Valve with O Ring	1411626
11	Torch Handle 19mm Diameter	1411627
◆ 12	Power/Gas Lead Assembly 3.8m	1411628
◆ 12	Power/Gas Lead Assembly 7.6m	1411629
NS	Neoprene Rubber 13.7m	1411674
NS	Protective Zip Cover 3.1m	1411672
NS	Protective Zip Cover 6.7m	1411673
NS	Torch Accessory Kit	1408020

<b>Torch Switch Plugs</b>		
NS	Plug 2-pin	1407817
NS	Plug 3 Pin	607574
NS	Plug 4 Pin	627018
NS	Plug 6 Pin	607771

<b>Optional</b>		
1/4" BSP	- 25mm <sup>2</sup> Dinse Gas/Power Adaptor	1407737

### KEY

- \* Collet Bodies include one collet of matching size
- ◆ Coaxial power/gas cable fitted with 1/4" BSP nut and bullnose fitting
- ▲ Items contained in accessory kit
- Consumable items supplied with torch
- NS Not Shown