

## Spare Parts PT-81 Plasma Cutting Torch

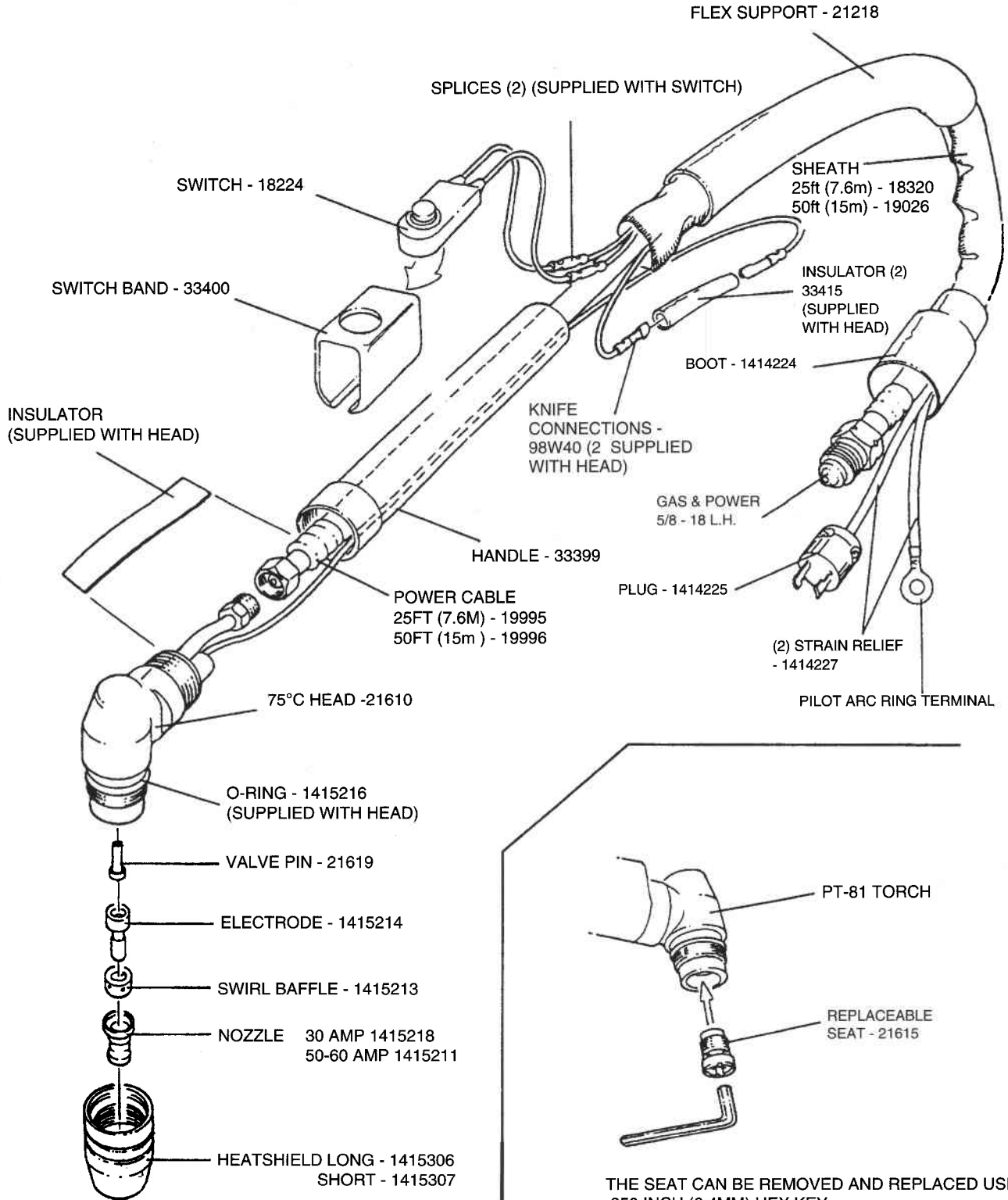

THE SEAT CAN BE REMOVED AND REPLACED USING A .250 INCH (6.4MM) HEX KEY.

ALL TORCH ASSEMBLIES AND REPLACEMENT HEADS ARE SUPPLIED WITH THE SEAT INSTALLED.

\*REPLACEMENT TORCHES ARE SUPPLIED WITH 50AMP NOZZLES