

TW451 4m TIG Torch
TW452 8m TIG Torch

1415026
1415027

450 Amps Max. Current DC -ve
350 Amps Max Current AC

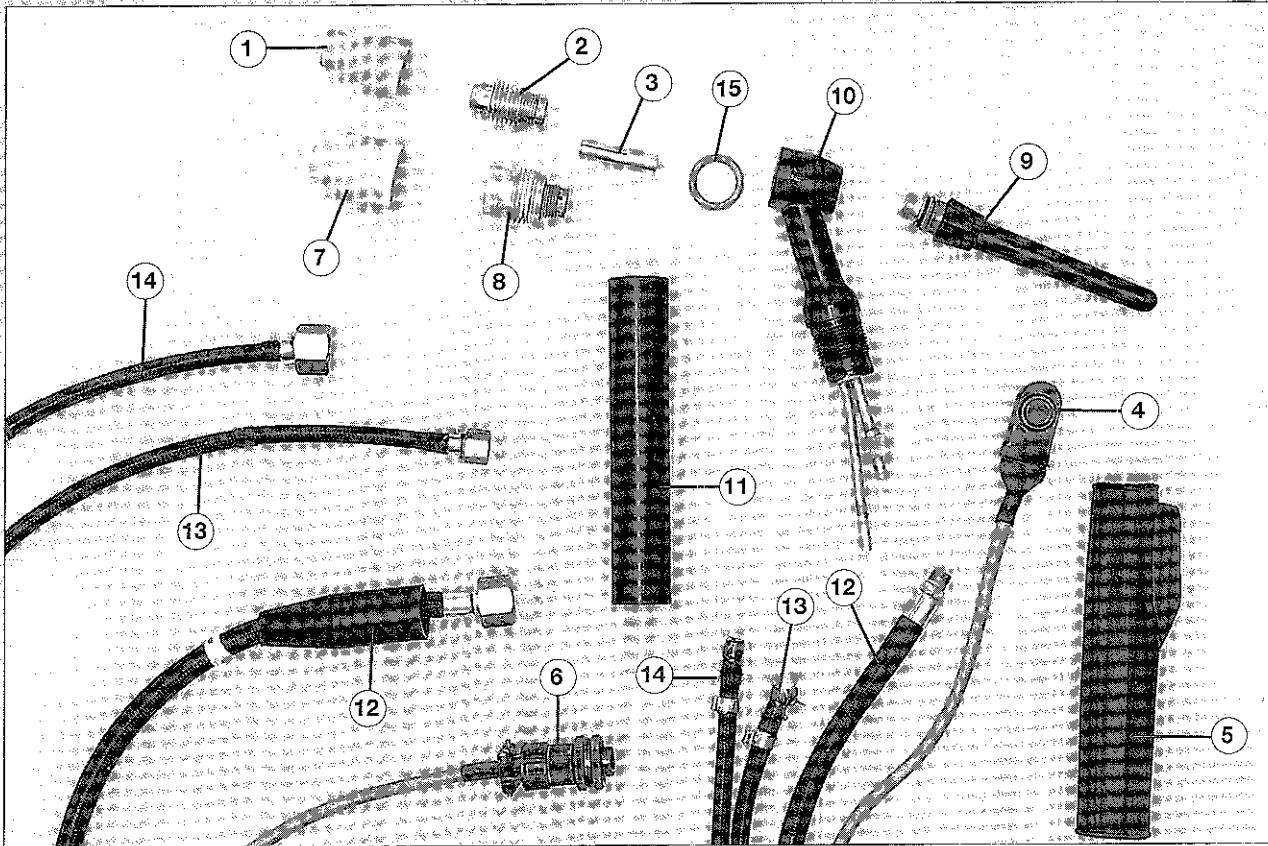

Nozzles / Collet Bodies

▲ 1	Ceramic Nozzle 38mm x 9.5mm Pk5	889688
● 1	Ceramic Nozzle 38mm x 13.0mm Pk5	889689
▲ 1	Ceramic Nozzle 38mm x 16.0mm Pk5	889690
● 2	Collet Body	606090

Collets

▲ 3	Collet 1.2mm Pk3	889796
▲ 3	Collet 1.6mm Pk3	889797
▲ 3	Collet 2.4mm Pk3	889683
● 3	Collet 3.2mm Pk3	889684
▲ 3	Collet 4.0mm Pk3	889685
▲ 3	Collet 4.8mm Pk3	889686
▲ 3	Collet 6.4mm Pk3	889687

Switches and Components

● 4	Momentary Switch	607541
● 5	Switch Boot Pk3	607663

Torch Switch Plugs

● 6	Plug 2 pin	1407817
6	Plug 3 Pin	607574
6	Plug 4 Pin	627018
6	Plug 6 Pin	607771

Optional

NS	3/8" BSP - 35mm ² Dinse Adaptor	1414762
----	--	---------

Nozzles / Gas Lens

7	Gas Lens Nozzle 40mm x 9.5mm Pk5	889699
7	Gas Lens Nozzle 40mm x 13.0mm Pk5	889700
7	Gas Lens Nozzle 40mm x 16.0mm Pk5	889701
8	Gas Lens Collet Body	606194
NS	Gauze Pack	889698
NS	Gas Lens Kit (Contains 1 off above items)	606180

Components

▲ NS	Short Back Cap	607756
● 9	Long Back Cap	607758
10	Torch Body	609041
11	Torch Handle	608811
● NS	Sheath TW451	609035
● NS	Sheath TW452	609034
◆ 12	Power/Water Cable TW451	1402239
◆ 12	Power/Water Cable TW452	1402240
+ 13	Gas Hose TW451	1402237
+ 13	Gas Hose TW452	1402238
■ 14	Water Hose TW451	1402232
■ 14	Water Hose TW452	1402233
* 15	O Ring Pack	889692
NS	Accessory Kit	607583

KEY

- ◆ Coaxial power/water cable fitted with 3/8" BSP nut and bullnose fitting
- + Gas hose fitted with 1/4" BSP nut & nipple
- Water hose fitted with 3/8" BSP nut and bullnose fitting
- NS Not Shown

- Consumable items supplied with the torch
- ▲ Items contained in the accessory kit
- * 'O' Ring pack contains: 5 x Nozzle 'O' rings
4 x Gas seal 'O' rings
1 x Back cap 'O' ring